

Thanks for purchasing our performance lower control arms. If you are not installing these yourself have a qualified shop do so. These arms are designed to be used with stock OEM spindles or Camburg performance spindles. Check the parts list to make sure you have every component prior to installing. Camburg Engineering has made every attempt to insure you receive the highest quality components in the most complete manner. This is a guide to help you through the process with some recommended torque specs & notes. It's your responsibility to ensure parts are being installed correctly using the correct tools and procedures. For step-by-step instructions refer to a Toyota or Haynes service/repair manual.

Important Installation Notes:

- Does NOT fit KDSS 4-Runner models
- When running larger than stock tires we recommend a zero offset wheel (maximum backspacing = 4.75")
- Re-uses lower OEM shock hardware and alignment cam hardware
- Use machined bump stop spacers with OEM rubber bump stops only
- Grease lower ball-joints prior to use or damage will occur using a grease gun with a tip/adaptor for flush fittings. We recommend using a high temp. lithium complex #2 synthetic grease.
- Apply anti-seize to uniball spacer surfaces (shaded gray in diagrams)
- Use RED loctite on all fasteners > 1/4" dia.
- Use BLUE loctite on all fasteners < 1/4" dia.
- Inspect and re-torque all hardware and components after the first 500 miles, inspect at your scheduled maintenance intervals and whenever using the vehicle off-road.
- We recommend greasing the ball-joints 2-3 times per year or every 5-8k miles depending on use, higher frequency lubing may be required when used off-road and/or in wet/snow/mud conditions.

Recommended Torque Specs:

- Lower Ball-Joint Castle Nut = 105 ft/lbs.
- Lower Ball-Joint Cradle M16 Bolts = 118 ft/lbs.
- Alignment Cam Hardware = 100 ft/lbs.
- Lower Shock Hardware = 65 ft/lbs.
- Outer Tie Rod Castle Nut = 67 ft/lbs.
- Bump Stop and Spacer = 25 ft/lbs.
- Ball-joint Upper Arm Castle Nut = 81 ft/lbs.
- Uniball Upper Arm Nut = 125 ft/lbs.

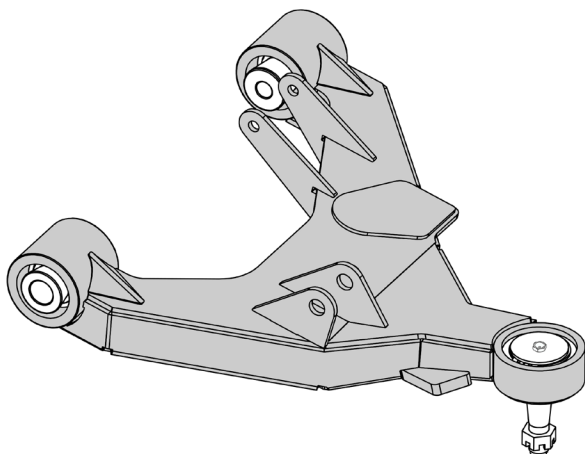

Fitment:

We've seen some frame inconsistencies with a small percentage of '09-10 Tacoma models due to poor manufacturing tolerances which may require different uniball spacers at the frame. If this is the case for you, give us a call and we will ship you a different version of spacers that have a 1/4" difference right away.

ID	PART NBR	DESCRIPTION	QTY
		DRIVER SIDE LOWER ARM	1
		PASSENGER SIDE LOWER ARM	1
5	960035	1.00 X 0.755" FRONT LCA UNIBALL FRAME SPACER (SHORT)	4
4	960083	1.00 X 0.562" REAR LCA UNIBALL FRAME SPACER (LONG)	4
21	960603-230	BUMP STOP LOWERING SPACER	2
22		FLUSH GREASE ZERK FITTING	2
15		M16 X 2.0 CASTLE NUT	2
16		COTTER PIN	2
	030017	CAMBURG 8.5" STICKERS	4

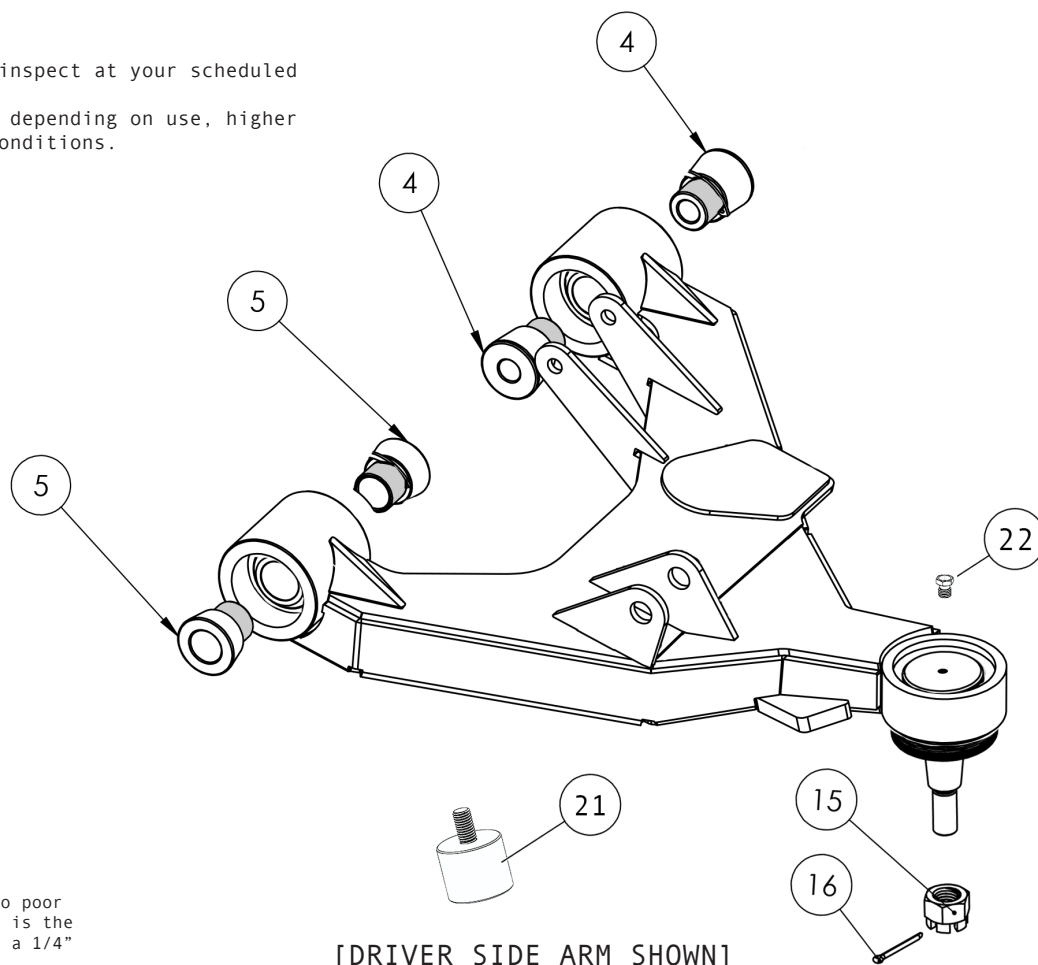

[DRIVER SIDE ARM SHOWN]